

## Product Size

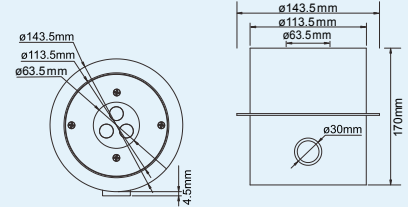

## Specification

<b>Model No.:</b>	RS-RP9W316X(88250) / RS-RP12W316X(88250)
<b>Front cover &amp; Housing:</b>	316L Stainless steel lamp body+Stainless steel 304 Niche
<b>Dimensions:</b>	D113.5*H170mm
<b>Tempered Glass:</b>	8mm thickness
<b>LED chip:</b>	CREE / EDISON
<b>LED Q'ty:</b>	3pcs 3W LED / 3pcs 3in1 LED / 3pcs 4in1 LED
<b>Cable gland:</b>	Stainless steel 316L PG13.5
<b>Driver:</b>	Constant current driver
<b>Lens:</b>	Bead
<b>Beam Angle Options:</b>	25° 40°
<b>Power Cable:</b>	AWG 5/18 or AWG 3/18 SOW rubber cable
<b>Protection Class:</b>	IP68
<b>Environment:</b>	Dry / Pool
<b>Mounting Hardware:</b>	Embedded System
<b>Net Weight:</b>	3.4kgs with 1.5m cable
<b>Lifetime:</b>	>50000H

## Order information

Item code	Color	Light source(w)	Line Way	Input Voltage (v)	Operating current (mA)	Consumption (w)	Luminous (lm)
88250.033.01	2700-3000K	3*3	V+/V-	AC/DC12-24	750 / 375	9	420
88250.033.02	4000-4500K	3*3	V+/V-	AC/DC12-24	750 / 375	9	445
88250.033.03	5000-5500K	3*3	V+/V-	AC/DC12-24	750 / 375	9	465
88250.033.04	6000-6500K	3*3	V+/V-	AC/DC12-24	750 / 375	9	465
88250.033.05	Red	3*3	V+/V-	AC/DC12-24	500 / 250	6	105
88250.033.06	Green	3*3	V+/V-	AC/DC12-24	750 / 375	9	270
88250.033.07	Blue	3*3	V+/V-	AC/DC12-24	750 / 375	9	120
88250.033.08	Yellow	3*3	V+/V-	AC/DC12-24	750 / 375	9	285
88250.033.09	RGB-DMX512 (3 channel)	3*3	V+ /V-/D+/D-/GND	AC/DC12-24	R: 166 / 83 B: 250 / 125 G: 250 / 125	R: 2 B: 3 G: 3	R: 35 B: 40 G: 90
88250.033.10	RGB-DMX512 (3 channel)	3*3in1	V+ /V-/D+/D-/GND	AC/DC12-24	R: 250 / 125 B: 250 / 125 G: 250 / 125	R: 3 B: 3 G: 3	R: 75 B: 90 G: 180
88250.033.11	Auto changing color	3*3in1	V+/V-	AC12-24	R: 250 / 125 B: 250 / 125 G: 250 / 125	R: 3 B: 3 G: 3	R: 75 B: 90 G: 180
88250.033.13	RGBV+ (build-in CC driver)	3*3in1	R/G/B/V+	DC12-24	R: 250 / 125 B: 250 / 125 G: 250 / 125	R: 3 B: 3 G: 3	R: 75 B: 90 G: 180
88250.034.14	RGBW-DMX512 (4 channel)	3*4in1	V+ /V-/D+/D-/GND	DC24	R: 250 / 125 B: 250 / 125 W: 250 / 125	R: 3 B: 3 G: 3 W: 3	R: 75 B: 90 G: 180 W: 270

